

Thank you for purchasing this KYONE Clipper, which sets the new standard in hair clippers. We hope you enjoy using your new Kyone Clipper.

Translation of the original user manual.

Instructions for use

For proper and safe use, please read the operating instructions and the safety instructions carefully and always follow them.

If you give/sell the device to someone else, ensure that the user manual is included with the device, and make sure that this person is a professionally trained person.

SAFETY INSTRUCTIONS

- This device is only for professional use in hairdressing salons, for cutting human hair, beard hair or eyebrows.
- This device is designed for indoor use only.
- Keep the device away from moisture, water and other liquids.

CAUTION!

Electric shock!



- **Do not use the device near a bath, shower, washbasin or other places where water or liquids are present. Also, do not operate the device with wet hands.**
- Only use the supplied charger/adaptor to charge the device.
- Do not immerse the device in water and do not rinse the device under water.
- Stop using the device if it has fallen into water.
- Do not handle the device if it has come into contact with water and immediately remove the plug from the socket.
- The device and the power cord must never come into contact with water.
- Make sure that no liquids get into the device.
- The plug may only be connected to alternating current. Check whether your mains voltage corresponds to the voltage indicated on the device.

CAUTION!

Risk of injury from the cutting head.

- Before each use, check that the blades are aligned and not overlapping to avoid injury.
- Never reach into or grasp the cutting head when the machine is switched on.
- The cutting head is a precision part. Protect it from damage and dust.

CAUTION! Ingestion of small parts:

Keep the device away from children.

- Also keep packaging materials, such as foil, away from children.

INSTRUCTION!

- Only use the supplied charger/adaptor to charge the device.
- Protect the supplied cable against damage and check it regularly for damage.
- Under no circumstances should the device be opened by the user. This may only be done by the distributor.
- Never attempt to remove dust or other contaminants from the inside of the unit using a pointed object such as a needle or pointed comb.
- Do not pull on the cable, always remove it by the plug. Make sure that the cable does not come into contact with hot objects.
- Never wrap the cable around the device.
- Do not expose the device to temperatures below 0°C or store above 40°C.
- Make sure that the cable is removed from the device and that the device is turned off before cleaning the device: before removing or placing the comb attachments or before removing the cutting head.
- Placing attachment combs that are not originally supplied with the device can lead to damage.
- Store the device properly and protect the device during transport in a means of transport that is suitable for lithium batteries.

INSTRUCTION!

- This appliance is not intended for persons with reduced physical, sensory or mental capabilities (including children), nor for persons without the necessary experience or knowledge to operate the appliance; unless under the supervision of a person with the necessary knowledge.
- Children should be supervised to ensure that they do not play with the device.

WARNING !! Stop using the device when:

- The device or part of the power cord is damaged.
- The device has been dropped, there is visible damage to the device or cutting head, otherwise skin damage may occur.
- The device is so damaged that electrical parts are visible.
- In any case, immediately remove the device from the mains power and contact the technical service.

INSTRUCTION!

- For added protection, it is recommended to install a residual current device (FI) with a rated activation current of no more than 30mA in the power circuit. Ask your installer for advice.

What you will find in the box:

- KYONE Clipper
- Charging base/docking station (on selected models!!)
- Adapter
- Attachment combs (1.5/3/4.5/6/10/13)
- Cleaning brush
- Oil bottle
- User Manual

Device operation.

Description.

- 1 Cutting head
- 2 Cutting head adjustment side lever
- 3 ON/OFF switch
- 4 Indicator light
 - (Blue/red is charging)
 - (Green/off is charged)
- 5 Attachment combs
 - (6 pieces: 1.5/3/4.5/6/10/13mm)



Using and charging the battery without a charging station.

The device contains a lithium battery. When the device is delivered, it is not yet fully charged. You should therefore fully charge the battery before using it for the first time. Before charging, make sure that the mains voltage corresponds to the voltage indicated on the device.

Connect the supplied adapter to mains power and then directly into the device. The battery only reaches its full performance capacity after a few charging cycles.

While charging, a BLUE/RED indicator light will be lit. When the battery is fully charged, the light will turn off/the light will be green.

Charging the battery while it is not yet (completely) empty does not affect the performance of the device. However, we recommend that you allow the battery to be completely discharged from time to time and

then fully charge it again to extend battery life.

- **Arrange the power cord so that no one trips over it.**
- **Keep the cord, device and adapter away from hot surfaces.**

Charging with a charging station. If included!

Check that the charging station is on a flat surface. Connect the supplied adapter to the charging station. Then plug the adapter plug into a working power outlet. Place the switched off device in the charging station.

Turning the device on and off.

The device is switched on or off with the on/off switch. (3)

Cutting length setting.

The cutting head can be adjusted to different lengths using the adjusting side lever (2).
0.5/1.5/2.5/3.5mm.



Adjustment of the cutting length using attachment combs.

The attachment combs can be placed on the cutting head for different cutting lengths. These are supplied with the device, in sizes 1.5/3/4.5/6/10/13mm. (5).

These are placed on the device with the help of a magnet in the attachment comb.

Cleaning and maintenance.

To maintain the optimum cutting performance of the appliance, you should regularly maintain the device. The best thing is cleaning and oiling every day.

➤ **Switch off the device and disconnect it from the mains.**

Remove the comb attachment from the cutting head, if in use.

Remove all hair and other contaminants with the supplied brush.

Carefully remove the cutting head from the device. (If possible)

Oil the cutting head; if you use the device regularly, we recommend that you do this before each use.

Oil all the parts of the cutting head that contact each other.

Only use the special oil supplied with the device (do not dilute, it will not hinder the course of the cutting head).

To clean the housing of the device, you can use a slightly damp (not wet) cloth. Do not use aggressive or abrasive cleaning agents when cleaning the device.

If the cutting head takes less hair after a while, it can be replaced with a new original one (available as a spare part from KYONE).

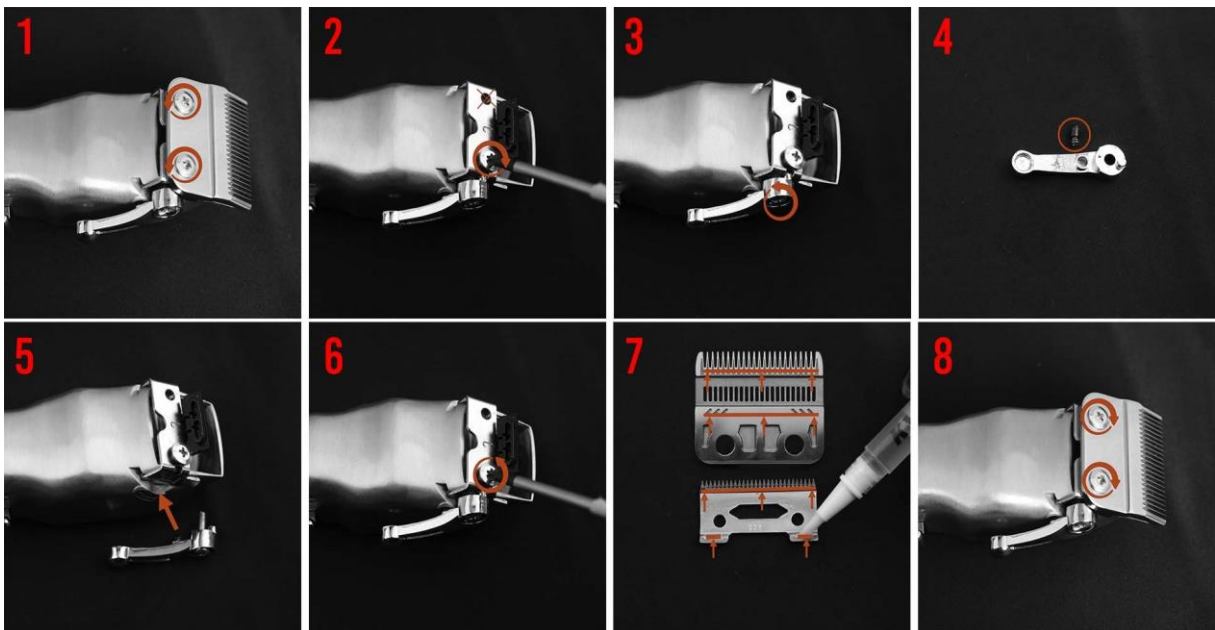

Cleaning the cutting head/Changing the side lever and/or making it infinitely adjustable

Step 1: Loosen both screws counter clockwise and take off the cutting blades. Leave the plastic part, including spring, in place.

Step 2: Just unscrew the right screw. This is to block the nut, so that you can loosen the screw of the side lever without it spinning.

Step 3: Remove the screw from the side lever by unscrewing it counter clockwise and put it next to the device.

Step 4: If you want to remove the click system, to be able to work continuously, remove the part that you see circled. Keep this safe!

Step 5: Replace the side lever and make sure to screw it back to the correct tension. Test this out by moving the side lever up and down. This varies per person, but make sure it is not too tight or too loose.

Step 6: You can now loosen the right screw clockwise again.

Step 7: Oil the blades at the points indicated.

Step 8: Replace the blades by tightening the screws clockwise. Do not tighten it completely yet, because you still have to check whether your cutting blade is straight and how short it needs to be adjusted. Set the blades short and straight, then tighten the screws securely. Make sure that the blades remain straight!

Storage.

Only store the device in a charged state if you are not going to use it for a longer period of time. Keep the device cool and dry and make sure that the device is protected against dust and other environmental influences.

Lithium Stage-3 battery.

The Lithium Stage-3 battery is a completely new type of lithium battery. This battery maintains its full capacity even after many charges.

Waste disposal.



This device is marked in accordance with the 2012/19/EU Directive on Waste Electrical and Electronic Equipment (WEEE). This electrical device may not be disposed of with normal waste at the end of its life, but must be handed in at a collection point for electrical equipment. This also applies to electrical appliances that were last used in the non-private sector but, for example, in industry or crafts. Insofar as the responsible, local, public waste disposal points do not accept non-privately used electrical appliances; their waste advice point provides information on environmentally friendly waste disposal.

The symbol on the product, the instructions for use or the packaging refers to this. The materials can be recovered according to their identification. The reuse, recycling of materials or other forms of recycling of waste equipment makes an important contribution to protecting the environment.



This electrical device contains a lithium battery. The battery should never be disposed of with normal waste. Owners of old devices should generally separate old batteries and old capacitors that are not enclosed by the old device before returning them to a collection point. This does not apply if the old appliances are handed in to public waste disposal companies (recycling point, recyclable materials point, etc.) and are separated there from other old appliances for the purpose of preparation for recovery.

Technical data.

Model: UCI-TAPER

Motor: DC-Motor

Battery: Lithium Stage-3

Battery life: up to 210 minutes

Cutting width: 45mm

Input: 220-240Volt - 50/60Hz - 200Ma

Output: 5Volt - 1000Ma

Cable length: 1.5 m

Charging time: full charge 180 minutes

Weight: 366g

Subject to technical modifications.

Illustrations in this manual may differ from the original.

Warranty

KYONE guarantees that its small electrical devices for professional use meet the legal warranty for all device parts not subject to wear and tear. The rights conferred by this warranty are in addition to the statutory and/or contractual warranty rights that the buyer has against the seller.

The warranty period starts with the delivery of the device. The date of delivery is determined by submitting the purchase receipt, invoice, packing slip or the like. The warranty period depends on the length of the statutory limitation period for material defects under the national law of the country where the device is purchased, but does not exceed 2 years. Defects that occur during the warranty period and which are reported to us in writing within three weeks of their occurrence, will be remedied without charge, subject to an inspection of proper use. Repairs must be carried out at our factory or at an authorized repair facility. Further claims by the customer under this warranty do not exist.

Excluded from the warranty are defects caused by:

- Improper use or lack of care.
- excessive strain, improper handling, damage from external influences.
- Non-compliance with the instructions for use.
- Repair or attempted repair not performed by KYONE or an authorized service partner.

Malfunctions caused by excessive use, incorrect handling and maintenance and by not following the instructions for use are excluded from the warranty. The same applies to defects caused by normal wear of the wearing parts (drive components, cutting head, shaving head, blades, combs, comb attachments, batteries).

If repairs are made under warranty, the replaced parts become the property of KYONE. KYONE is entitled to remedy the defect by supplying a device of the same construction. Further rights of the customer under this warranty, in particular reimbursement of expenses, discount, compensation or the right of withdrawal do not exist. Legal or other contractual claims due to the defect of the item remain unaffected. The fulfilling of warranties does not extend the warranty period.

If our customer service department receives an unjustified warranty claim, we reserve the right to charge the customer for the costs incurred.

If any defects have occurred, please contact the distributor of the device or the KYONE service partner in your country or region.

Spare parts.

Only use original spare parts that you can order from the KYONE service partner.

SYMBOL DESCRIPTION ON THE POWER SUPPLY UNIT



Protection class II symbol: Devices with protection class II have reinforced or double insulation.



House symbol: The device is designed for indoor use only.

Sold by:
Head-Works Trading
Dorpsstraat 25
4511 EB Breskens
The Netherlands

Made in China

WARRANTY

In case of complaints, warranty claims and any necessary repairs, include this fully completed voucher along with the device.



Head Works
ELECTRONICS

Date of purchase

Signature

